

HADEF Spur Gear Hoist

Type 12/12

- Lifetime guarantee for the sintered brake lining (1)
- Low maintenance due to sintered brake linings
- High quality surface treatment of the unpainted parts
- Rigid construction and steel housing
- Reinforced safety catch of suspension and load hook
- Light hand chain pull

Bolt for easy exchange of hook or assembly with trolley



Should the sintered brake linings be worn, please return the ratchet wheel to us and we will send you free of charge a new ratchet wheel with sintered brake lining. Costs for installation of the new parts will not be refunded.



capacity kg	chain falls	load chain mm	hand chain mm	lift at 30 m hand chain mm	hand chain pull ca./ approx./env daN	weight poids	
						at 3 m suspension height ca. kg approx. kg env. kg	per m add. lift ca. kg approx. kg env. kg
500	1	5 x 15	4,8 x 22	1112	23	7,5	1,5
1000	1	6,3 x 19,1	5 x 25	690	28	13	1,8
1500	1	7,1 x 21		519	34	16	2,1
2000	1	8 x 24		423	35	23	2,3
3000	2	7,1 x 21		260	35	24	3,2
5000	2	9 x 27		151	33	41	4,4
7500	3	9 x 27		101	34	57	6,2
10000	4	9 x 27		76	35	66	7,9

Type 12/12

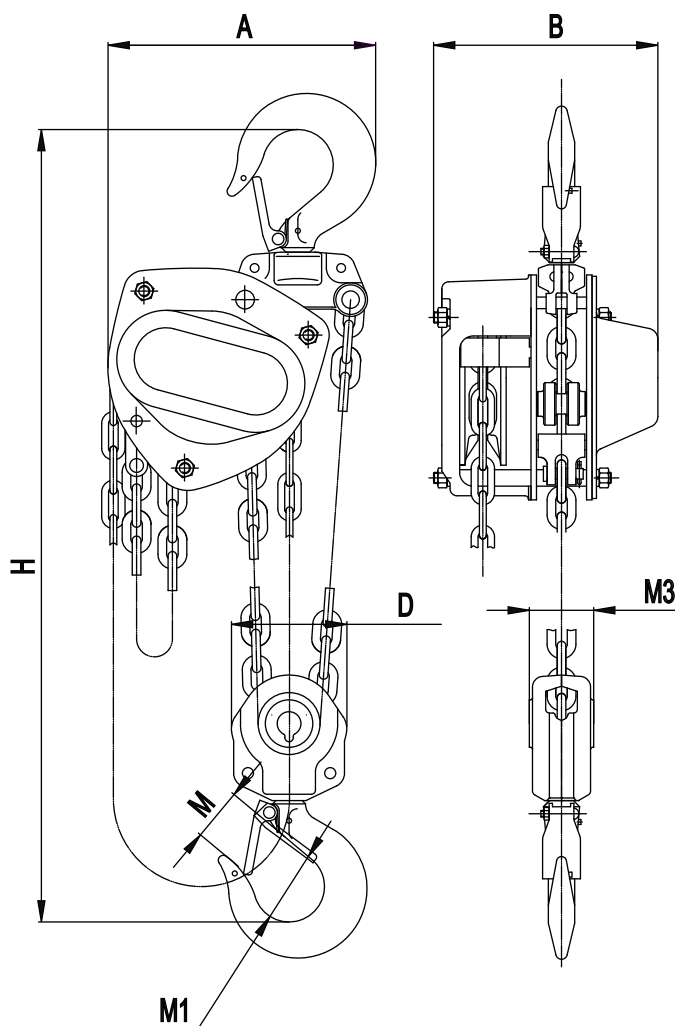

keit capa- city kg	main dimensions in mm						
	A	B	D	M	M1	M3	H
500	139,5	131	43	27	32	25	285
1000	161	162	51	33	40	30	315
1500	182	170	64	33,5	42	34	380
2000	202,5	184	64	37	46	34	404
3000	235	170	106	43,5	52	53	524
5000	282	192	133	51	60	64	687
7500	373	192	120	64	85	70	825
10000	360,5	192	263	64	85	95	820